

WALL BRIDGING UNIT

1. Insert fittings into End Panel as shown. Mirror for the other End Panel.

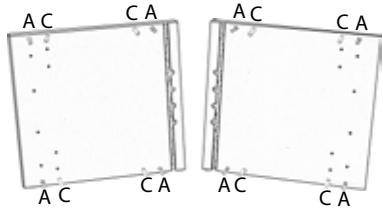

2. Insert the circular cams B into the holes in the bottom panel, ensuring that the arrows point towards the drilled edge. Push the panel firmly home onto the end panel. Using a screwdriver, turn the cam clockwise to lock. Repeat for the top panel.

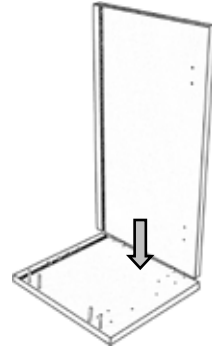

3. Slide the back panel into the grooves in the top and bottom panels, and push home into the end panel.

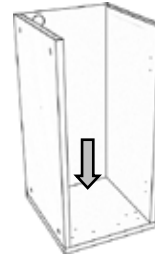

4. Place the remaining end panel over the other panels and push firmly home, ensuring that the back panel locates into the groove. Lock the cams as before.

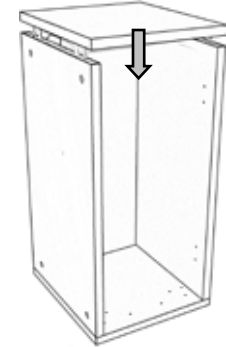

NOTE: These instructions use a medium wall 600mm bridging unit. The medium wall 900mm and high wall bridging unit are assembled in the same way.

5. Knock the hanging bracket into the holes as shown. Fix with two K screws per bracket into the top panel - use the ANGLED holes. Repeat for the remaining hanging bracket.

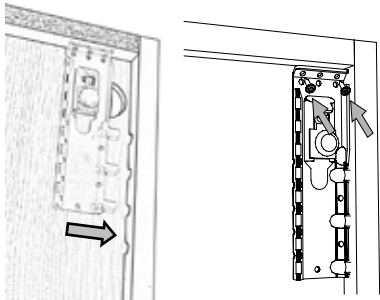

6. Viewed from the inside of the cabinet, use the upper hanging bracket screw for height adjustment, and the lower screw for pulling the cabinet tight into the wall.

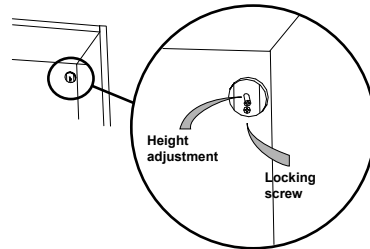

7. Fix the flap hinge stay to the end panel.

For instructions to fit the flap stay, turn over.

FITTINGS SUPPLIED

A		Metal Dowel	8	M		Euroscrew 6 x 11mm	4
B		Metal Cam	8	N		Round Head Screw 6 x 5/8mm	4
C		Wooden Dowel 8 x 40mm	8	S		Door Buffer Pad	1 pair
E		Connecting Screws (M/F)	2 pairs	T		5mm Bung	16
H		Countersunk Screw 6 x 5/8"	3	U		35mm Bung	2
K		Flange Head Screw 6 x 3/4"	4	W		Hanging Plate	2

WALL BRIDGING UNIT - FITTING THE FLAP STAY

1. Secure the flap bracket to the flap in the pre-drilled holes.

PLEASE NOTE: The flap bracket has to be placed in a VERTICAL position with the slot facing forwards.

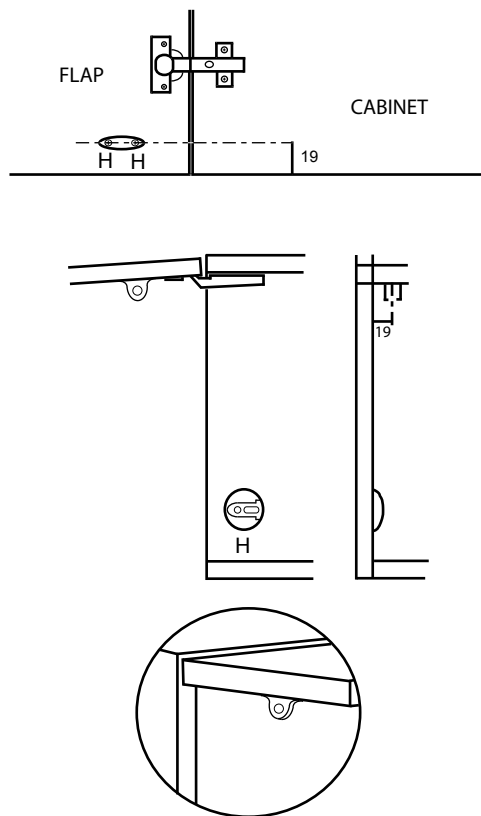

2. Secure the side bracket to the carcass in the pre-drilled holes as shown.

PLEASE NOTE: The side bracket has to be placed in a HORIZONTAL position, and the open end facing the wall.

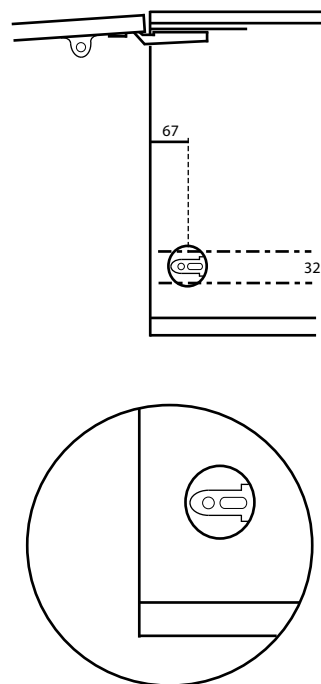

3. Slide the flap stay into the flap bracket, and into the side bracket as shown.

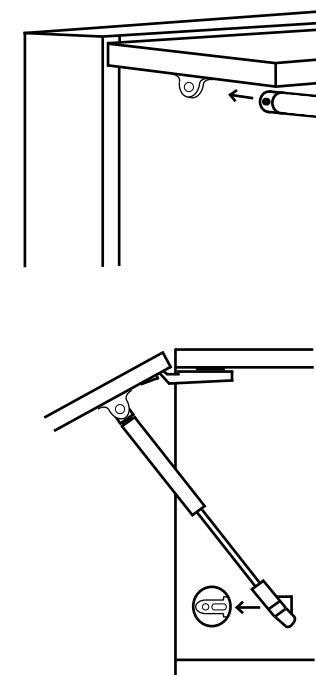

FITTINGS SUPPLIED



1 x Mechanism



1 x Flap Bracket



1 x Side Bracket

The opening and closing of the door can be changed by adjusting the position of the piston base plate within the slot.

- Forwards Adjustment - the door opens automatically later (automatic stay only) and closes automatically in advance (both stays automatic and friction)
- Backwards Adjustment - the door opens automatically in advance (automatic stay only) and closes automatically later (both stays automatic and friction)

