

TAMBOUR UNIT ASSEMBLY INSTRUCTIONS

1. Insert fittings into End Panel as shown. Mirror for the other End Panel.

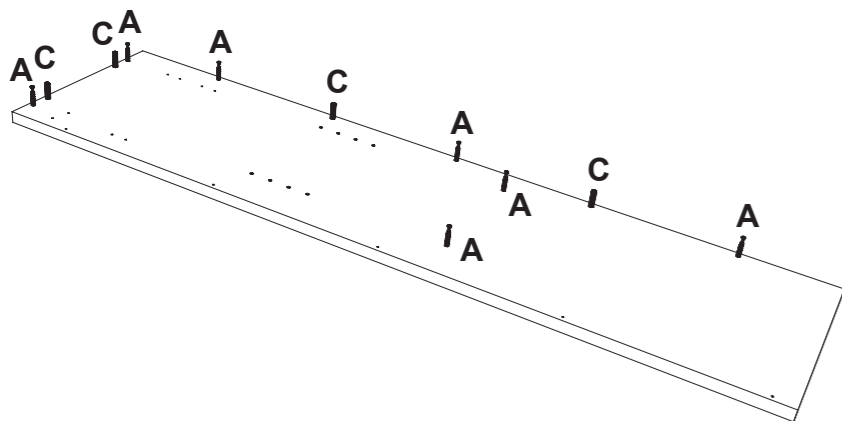

2. Insert the circular cams B into the holes in the top panel and fixed shelf, ensuring that the arrows point outwards. Note that the top panel is grooved - this groove should be kept to the inside of the unit as shown. Push the panels firmly home onto the end panel. Using a screwdriver, turn the cam clockwise to lock.

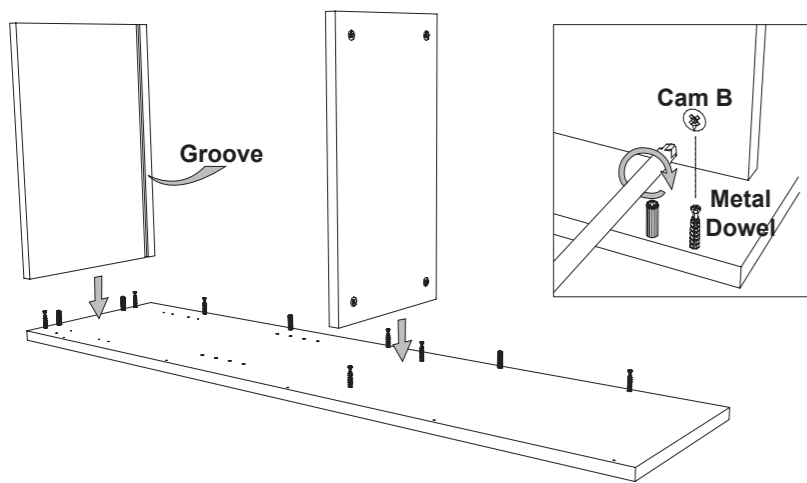

3. Fit the back panel as shown. Lock the cams as before.

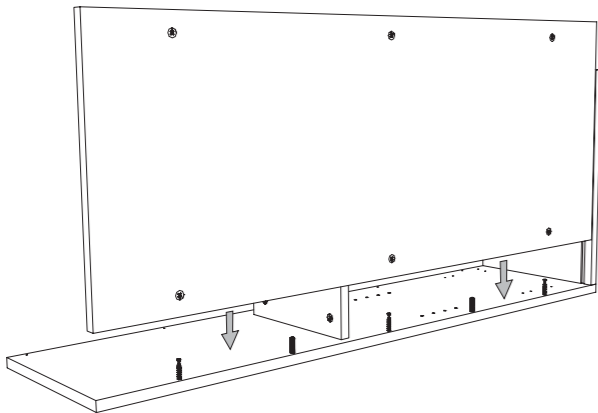

4. Fit the remaining end panel as shown. Lock the remaining cams as before on the top panel, fixed shelf and back panel.

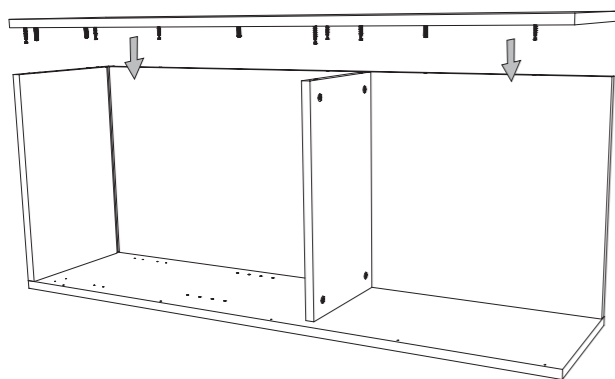

5. Slide the sprung loaded roller onto the last section of the plastic end of the tambour carpet as shown. Ensure that the tape is on the inside.

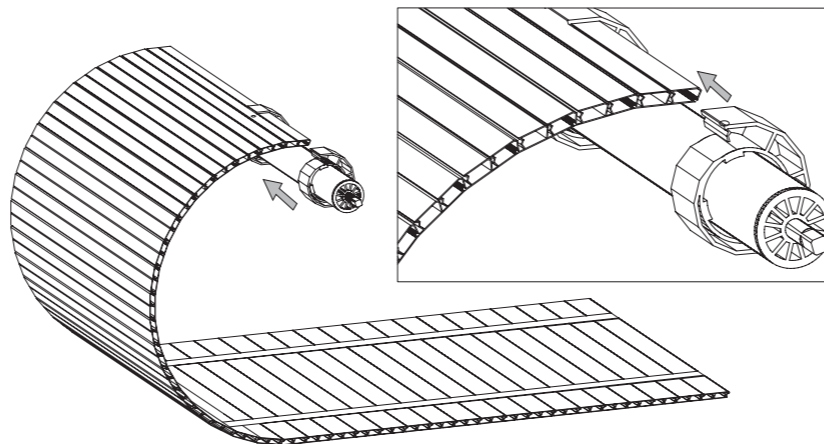

6. Ensure that the right hand end of the spindle is 8mm in from the edge of the carpet, and then fix with two H screws as shown.

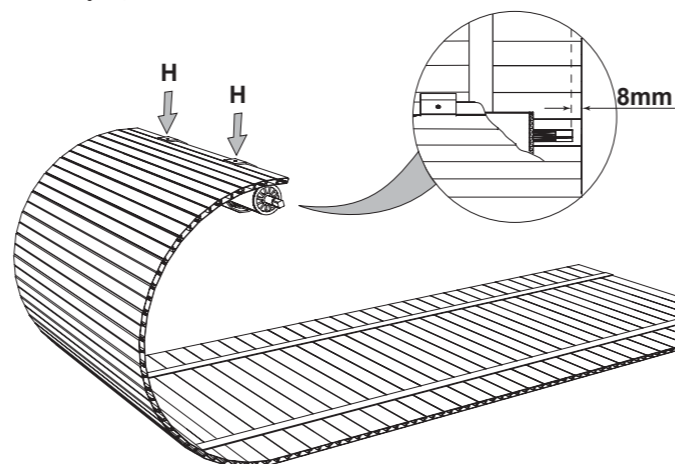

7. Roll the tambour carpet up, and then hold together using a piece of sticky tape as shown. Place the rubber circle around the clip, and push onto the guide roller, securing in the grooves. Insert the guide roller accessory into the holes on the end brackets. Push the end brackets onto the tambour carpet and guide roller, ensuring that the carpet is the correct way round.

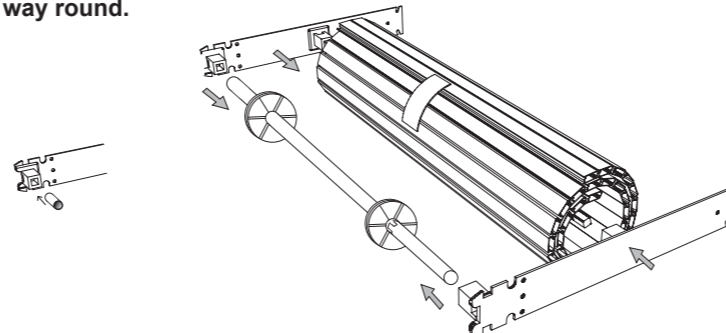

8. Lay the tambour cabinet on its back, and place the tambour assembly into the cabinet. Screw the tracks into the side panels using F screws, ensuring the cut-outs are at the top of the cabinet. Fix the pelmet to the inside of the top panel using F screws.

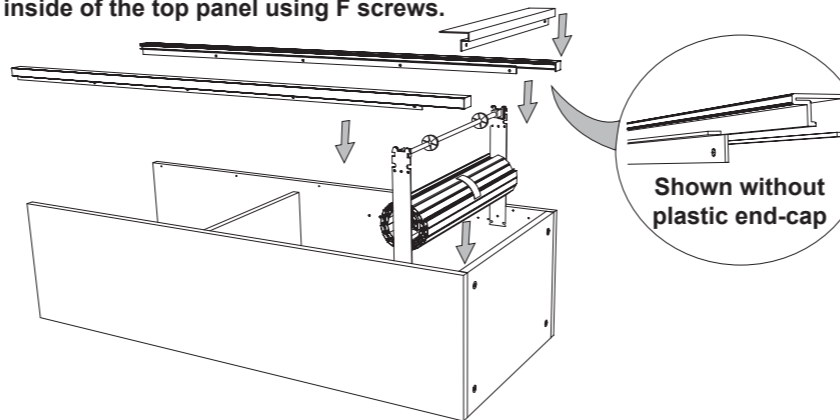

9. Insert G shelf studs into the holes shown on both end panels. Push the tambour assembly onto the front shelf stud (see first sketch), and then raise it against the back shelf stud (see second sketch). Fix to both end panels using F screws in the holes shown.

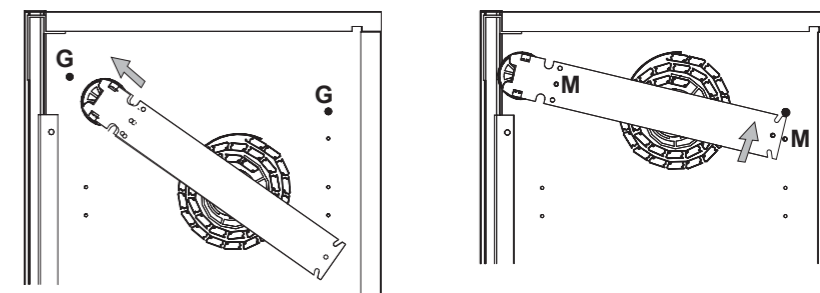

10. Assemble the limits stops, by inserting the two long screws into the smaller black rubber cap, followed by the larger black rubber cap (see first sketch). Ensure the smaller rubber cap is pulled right up over the head of the screw. Once assembled insert the two limit stops into the holes on the rear of the handle and secure by tightening the screw.

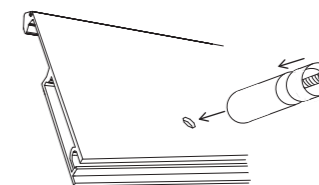

Rotate the tambour roll FIVE TIMES to give the correct tension (if looking at the carpet as shown above rotate anti-clockwise). Release the sticky tape, and feed the tambour carpet around the guide roller and into the track grooves. Pull the tambour carpet all the way past the end of the tracking, slide the handle onto the carpet, and then allow the carpet to return slowly to the top.

11. Insert G shelf studs into the upper set of holes on both end panels as shown. Pull the tambour carpet past these holes and the lower set, ensuring that the limit stops are also below the lower set. Push the loose top panel against the shelf studs as shown, and then insert the remaining shelf studs underneath the shelf to hold it in position. Place the lower loose shelf as required.

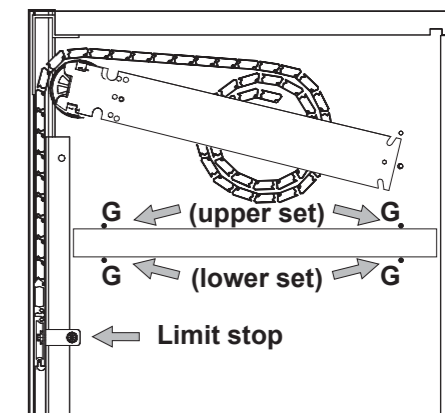

FITTINGS SUPPLIED	CABINET ASSEMBLY	TAMBOUR FITTING
A Metal Dowel	14	
B Metal Cam	14	
C Wooden Dowel	8	
E Connecting Screws (M/F)	3 pairs	
J Countersunk Screw 6 x 1/2"		2
L Flanged Screw 6 x 5/8"		16
M Euroscrew 6 x 11mm		4
P Shelf Stud	4	
Q Rubber Sleeved Shelf Stud		12

