

# BASE CHISEL END UNIT

1. Insert fittings into End Panel as shown. **PLEASE NOTE** - the diagrams below depict a Right Hand Chisel End. To construct a Left Hand Chisel End, mirror the back fittings (A, A and D) in both End Panels.

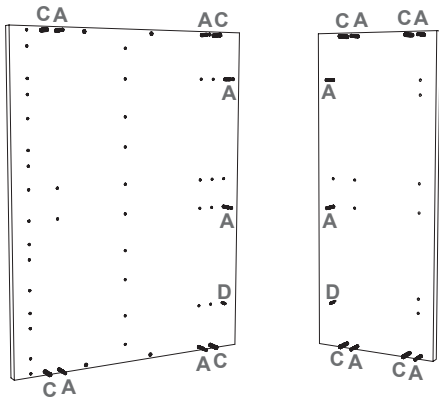

2. Place the bottom panel on a flat surface and push the feet blocks into the holes as shown. Hit the spigots marked 'X' with a hammer. Secure the feet blocks with two H screws, ensuring the feet blocks overhang the edge, where possible, to provide extra support.

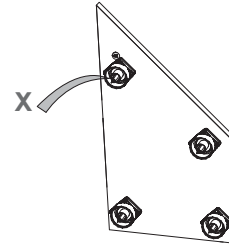

3. Insert the circular cams B into the holes in the bottom panel as shown, ensuring that the arrows point towards the drilled edge. Push the panel firmly home onto the end panel. Using a screwdriver, turn the cam clockwise to lock. Repeat for the top panel.

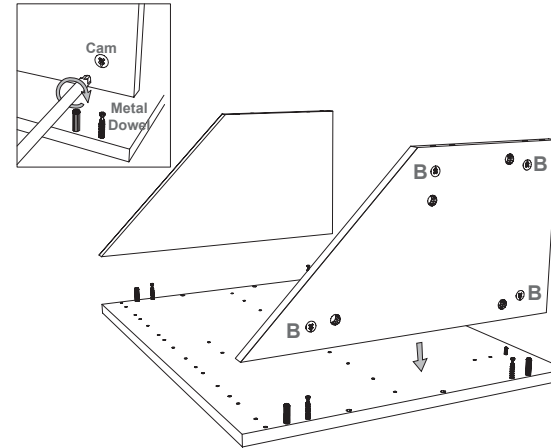

4. Fit the back panel to the end panel. Lock the cams as before.

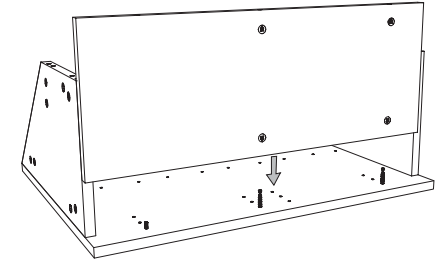

5. Fit the remaining End Panel to the bottom, top and back panel. Lock the cams as before.

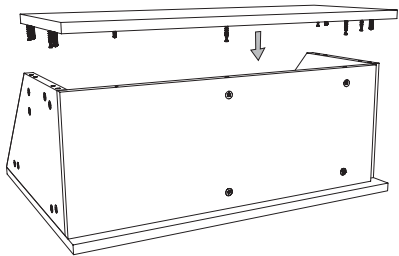

6. Knock the feet into the blocks, and adjust for height as necessary.

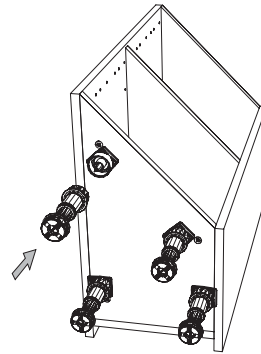

7. When fitting the unit, ensure that there is a 19mm step to the shallower adjacent unit as shown.

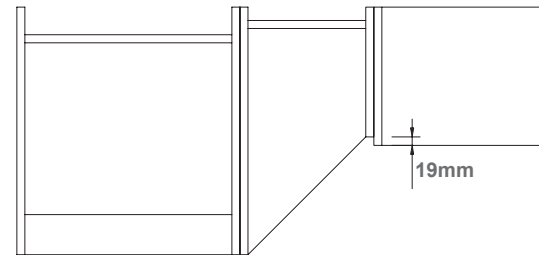

8. Use top position for full height doors, lower position if using a drawer. Ensure that the arrow on the plate points to the front.

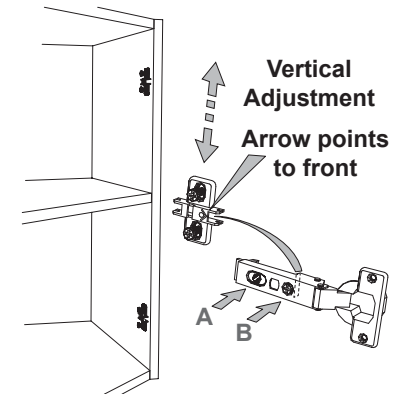

FITTINGS SUPPLIED											
<b>A</b>		Metal Dowel	<b>12</b>	<b>H</b>		Countersunk Screw 6 x 5/8"	<b>8</b>	<b>S</b>		Door Buffer Pad	<b>2</b> pairs
<b>B</b>		Metal Cam	<b>12</b>	<b>J</b>		Countersunk Screw 6 x 1/2"	<b>4</b>	<b>T</b>		5mm Coloured Bungs	<b>14</b>
<b>C</b>		Wooden Dowel 8 x 40mm	<b>10</b>	<b>K</b>		Countersunk Screw 6 x 3/4"	<b>4</b>	<b>Z</b>		Plinth Clip	<b>2</b>
<b>D</b>		Wooden Dowel 5 x 25mm	<b>2</b>	<b>P</b>		Shelf Stud	<b>4</b>				
<b>E</b>		Connecting Screws (M/F)	<b>3</b> pairs	<b>R</b>		90° Angle Bracket	<b>2</b>				

**NOTE** - Use the hinges and plates supplied with the cabinet, NOT the ones supplied with the door.

To align doors, loosen screw A first. Use screw B to level doors, then re-tighten screw A.

